

Instructions for Downloading, installing and Using the survey App

Step 1 : Click on the download Icon to Download the app in your Mobile .

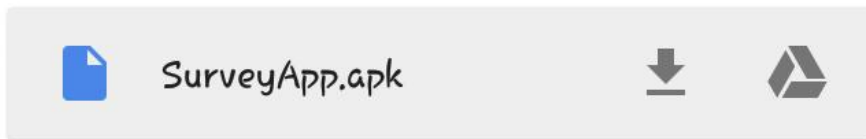

←
Reply

↩↩
Reply all

→
Forward

Step 2 : As Installation will start it will show on message saying installation blockage . So click on setting
And Click on option Unknown Sources set it to allow .

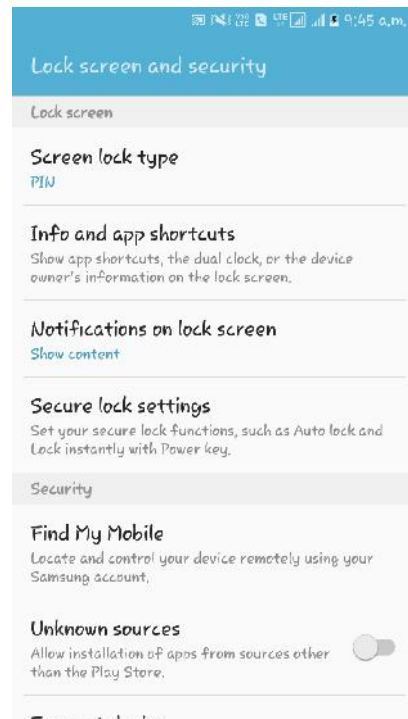
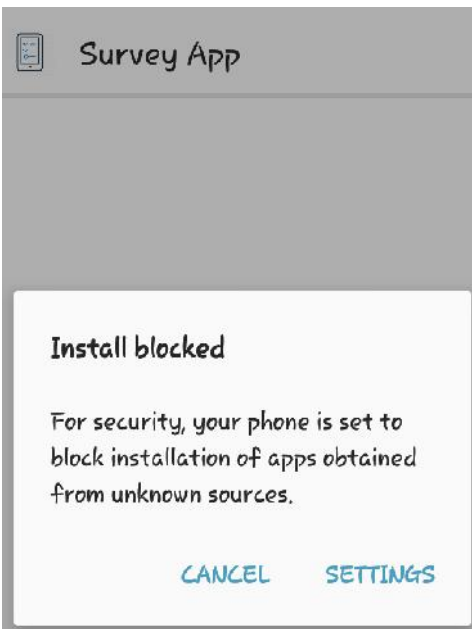

After that it will show a message asking for the permission, and as we will click ok it will show a screen to install the application

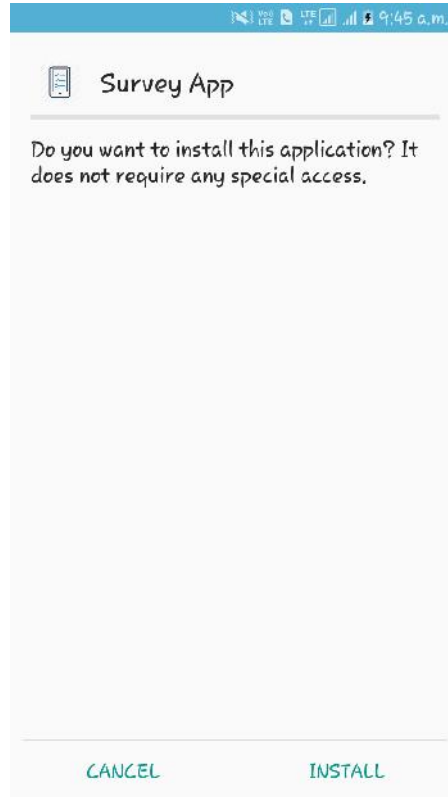
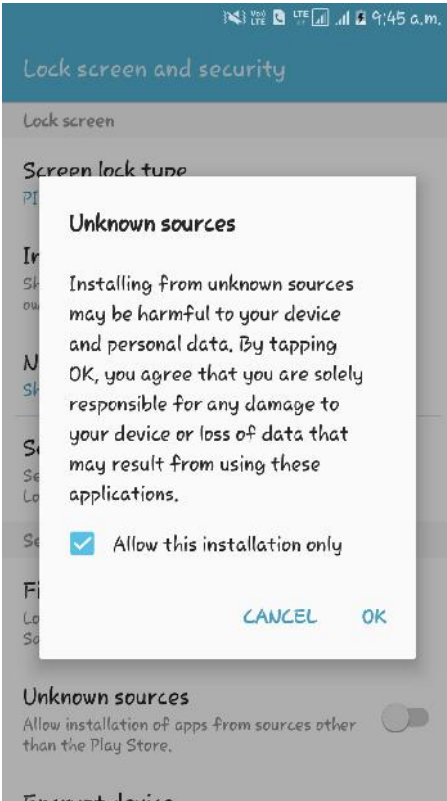

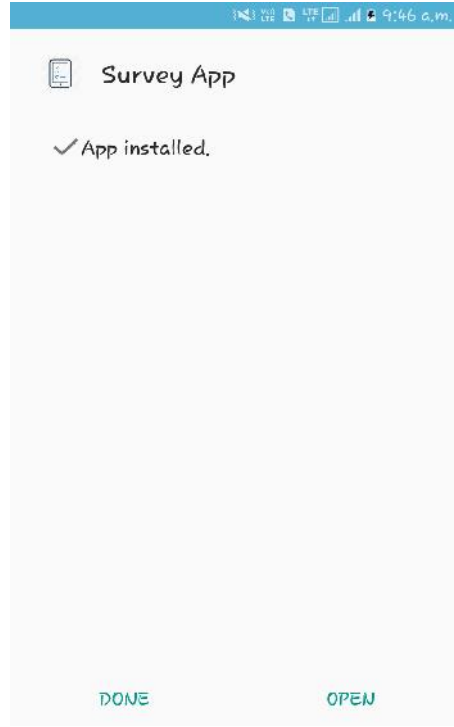
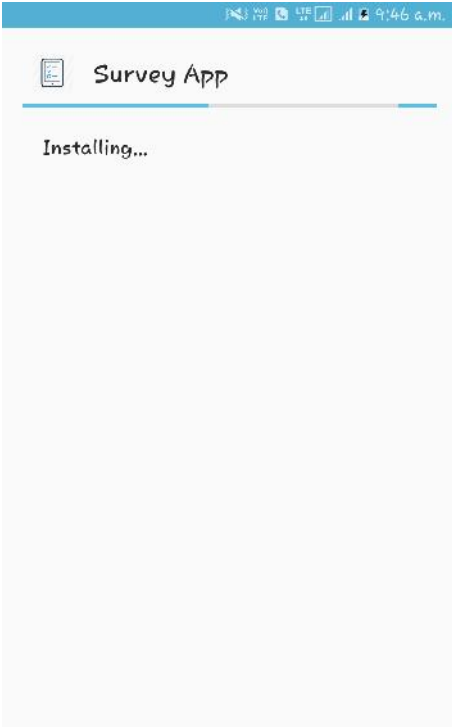

Step 3 : As installation will be complete, and when the application will start for the first time it will ask for following permissions; allow them all.

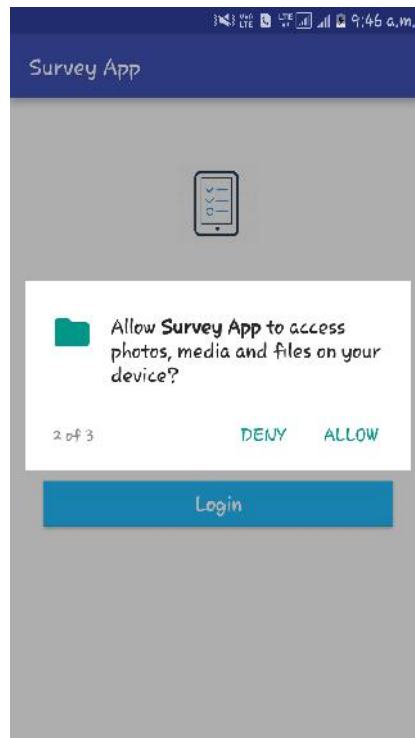
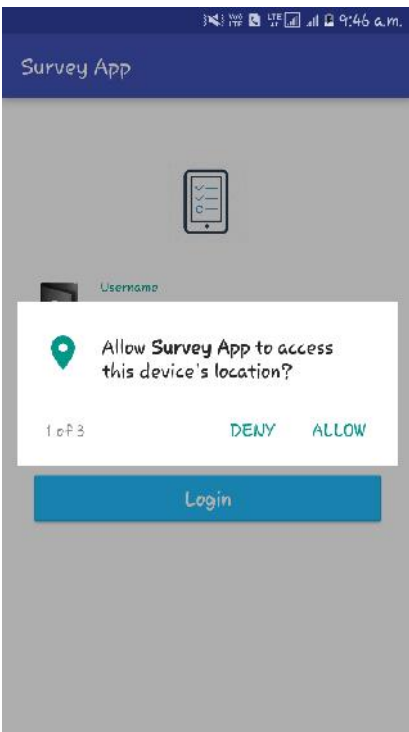

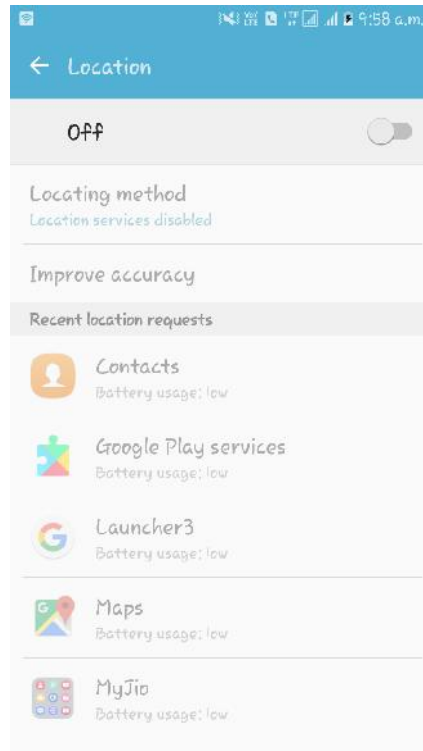
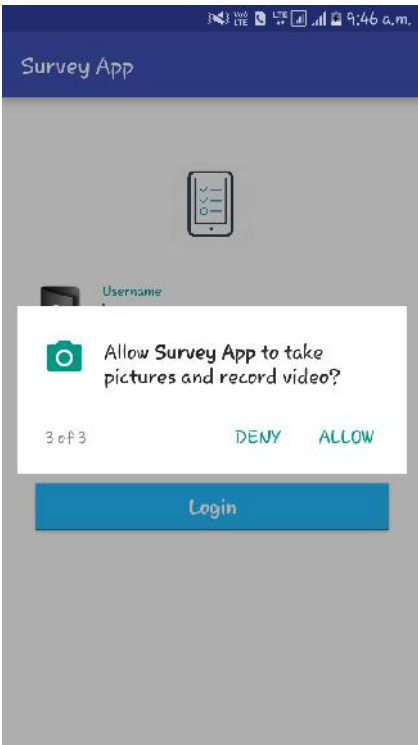

Step 4 : Once the installation is complete you can start using the application for doing the survey just by login the application and select the survey form.

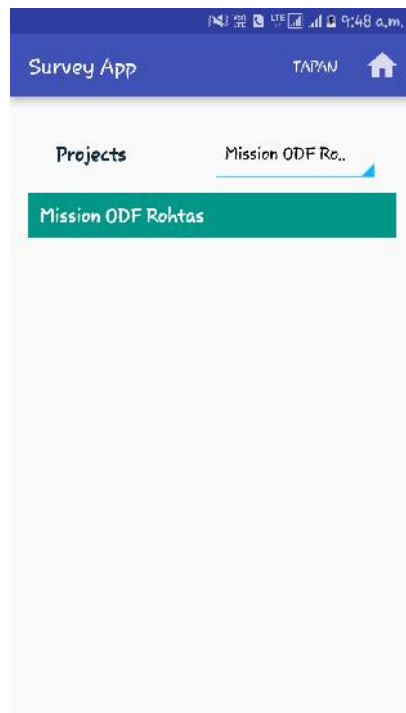
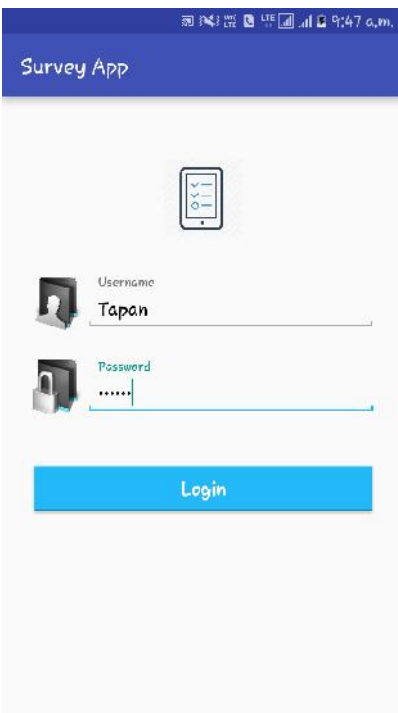

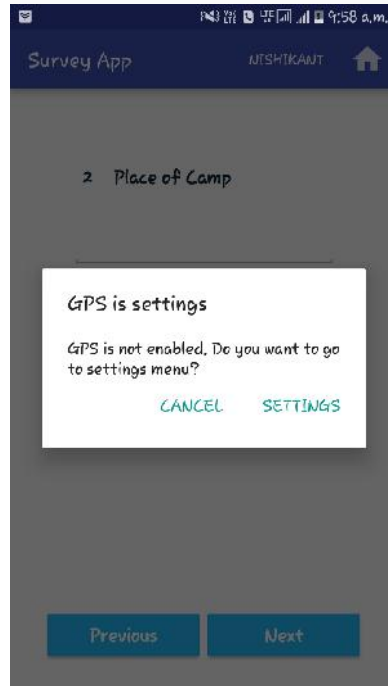
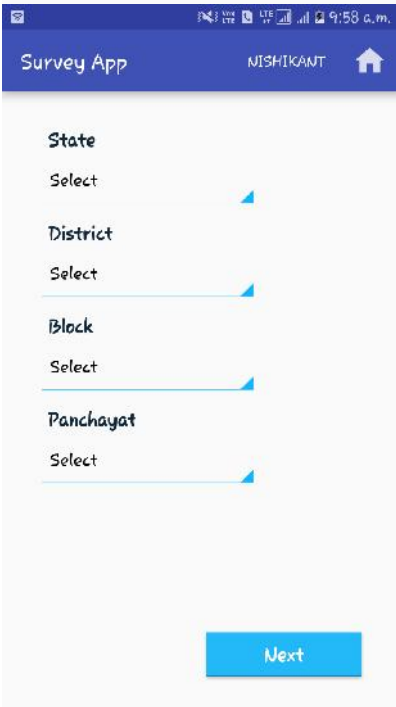
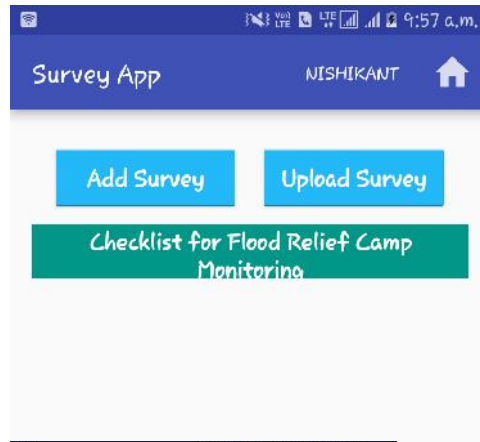
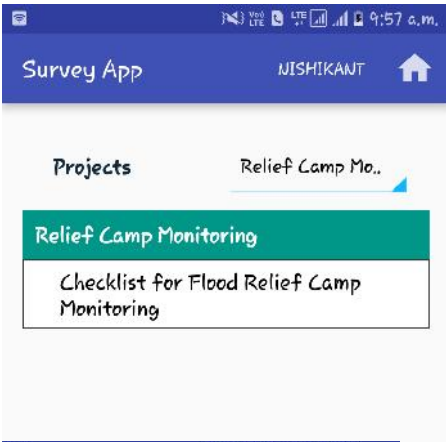

If GPS location is not enabled it will ask to start it

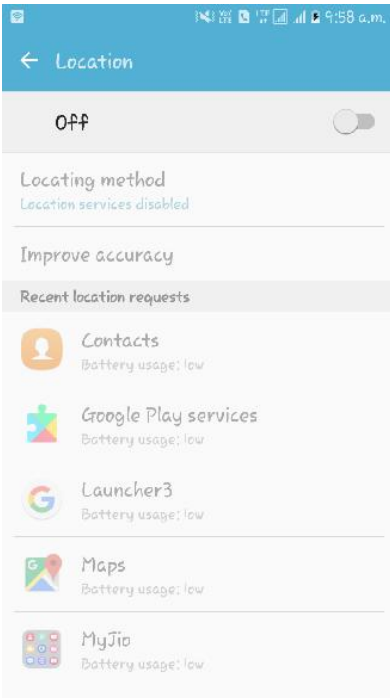

In a Question when image will be needed . you need to click on the camera icon.



After clicking on the image. Click ok to save the image.

After the survey is complete we need to upload the survey.

One by one or all responses in one go when you have the internet connectivity

